



Carters Mead | | Harlow | CM17 9EX

£1,500 PCM





Carters Mead |  
Harlow | CM17 9EX  
£1,500 PCM

A TWO DOUBLE BEDROOM END TERRACE HOUSE located directly opposite Potter Street Academy. The ground floor comprises of a lounge diner and modern fitted kitchen with gas cooker, washing machine, fridge and freezer. The first floor features two double bedrooms and a white bathroom suite with shower over bath. Other features include gas heating via radiators and UPVC double glazed windows. The rear garden is laid to lawn with use of a garage for storage (please note that there is no vehicular access into the garden or garage). This property is available unfurnished NOW. Sorry no smoking or pets.

- Two Double Bedrooms
- End Terraced House
- Unfurnished
- Available NOW
- Council Tax Band: C
- EPC Rating: C

Front

Entrance Porch  
6'2" x 3'9" (1.88m x 1.14m)

Hallway  
6'0" x 9'0" (1.83m x 2.74m)

Kitchen  
11'7" x 7'5" (3.53m x 2.26m)

Living Room  
10'11" x 20'11" (3.33m x 6.38m)

Landing  
5'9" x 6'10" (1.75m x 2.08m)

Bedroom One  
14'2" x 8'11" (4.32m x 2.72m)

Bedroom Two  
9'4" x 11'9" (2.84m x 3.58m)

Bathroom  
4'10" x 5'6" (1.47m x 1.68m)

WC  
2'6" x 4'10 (0.76m x 1.47m)

Garden

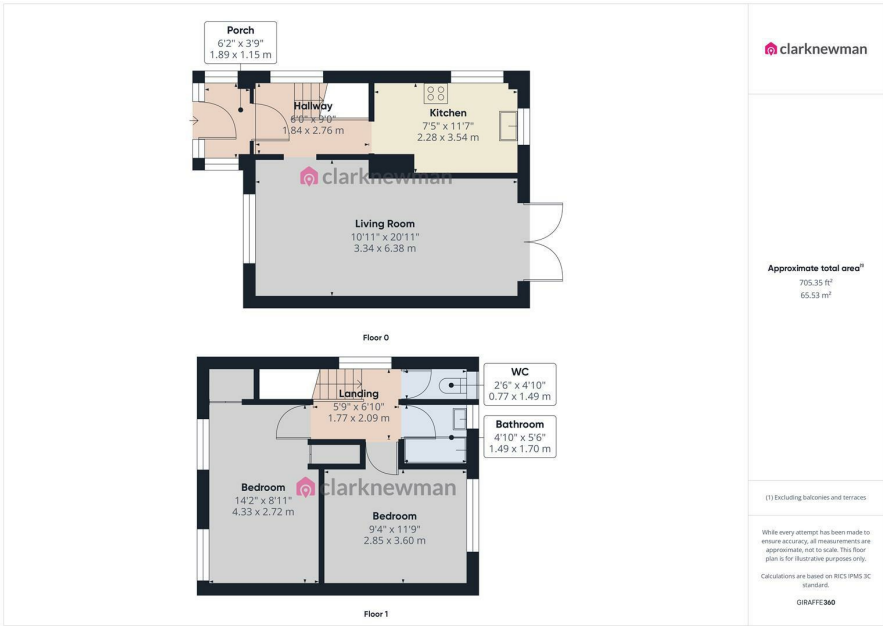

Energy Efficiency Rating		
	Current	Potential
Very energy efficient - lower running costs		
(92 plus) A		86
(81-91) B		
(69-80) C	71	
(55-68) D		
(39-54) E		
(21-38) F		
(1-20) G		
Not energy efficient - higher running costs		
England & Wales		EU Directive 2002/91/EC

Equity House  
4-6 Market Street  
Harlow  
Essex  
CM17 0AH  
01279 400444  
hello@clarknewman.co.uk  
www.clarknewman.co.uk